

# Staging

- Currently the staging area and facilities available include over 15,000 square feet of open dividable space including secure office/meeting area. The cabinet layout will determine the space required for staging. The costing and charges will be adjusted accordingly to actual requirements.
- The staging area can provide sufficient electrical power for all equipment under test to be energized. Both 24VDC and 120 VAC, 60 Hz power as a standard. Adequate building grounding will also be in place.
- Additional power requirements can be made available. Excessive power requirements for panel testing are to be discussed with the project manager at time of order.
- Customer supplied cabinets and equipment will require a power requirement schedule.
- Custom-sized areas can also be made available for the client, which would be determined prior to proposal. Any deviations shall be identified and flagged with all options and/or opportunities identified in a separate section titled "Options and Deviations". Prices will be detailed in a clear and concise manner so equipment additions or deletions can be made without a total requote.

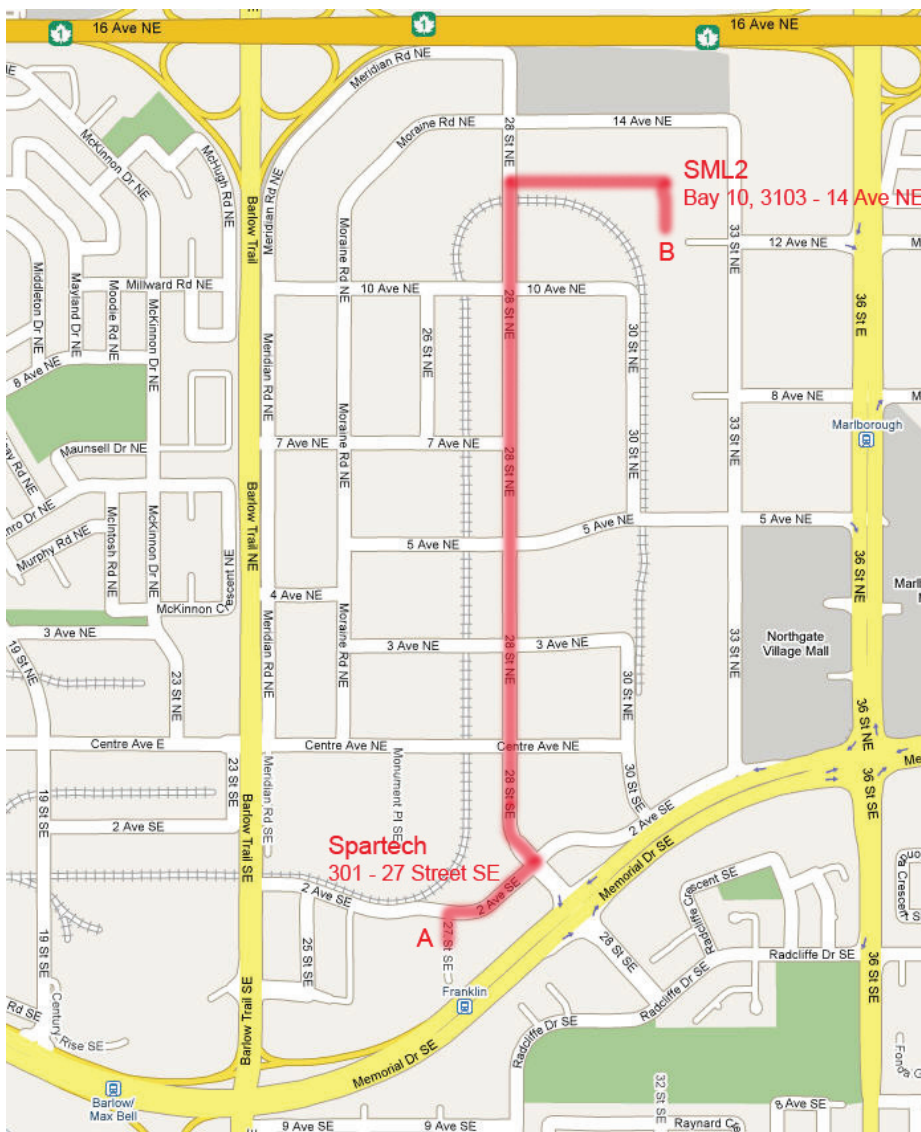

www.spartechmanufacturing.com

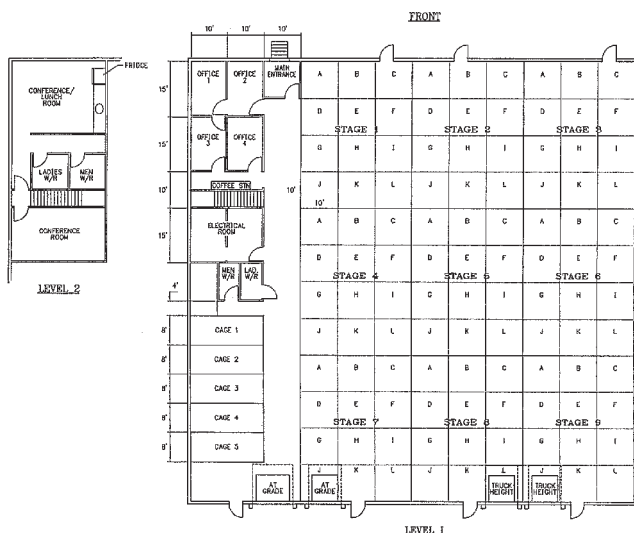

### CSA Approved

We are CSA and CSA<sub>US</sub> approved for in-house certification of custom assemblies for hazardous locations and general purpose areas. We can also manufacture to meet other standards, which include Cenelec, CE, ATEX, and SAA.

In-house certification of the following:

- Class 1 Div1/Zone1
- Class 1 Div2/Zone2
- Groups A, B, C and D
- General Purpose 600Vac 200 Amps

[www.spartechmanufacturing.com](http://www.spartechmanufacturing.com)

301 – 27 Street SE, Calgary, AB T2A 7V2

Phone: (403) 273-5775

Toll free: (877) 278-6404

Fax: (403) 207-0656

